

PRODUCT NO.	PIN S1-S7 & PI-PI5	PIN S8-S16
10035202-001LF	YES	YES
10035202-001TRLF	YES	YES
10035202-011LF	YES	NO

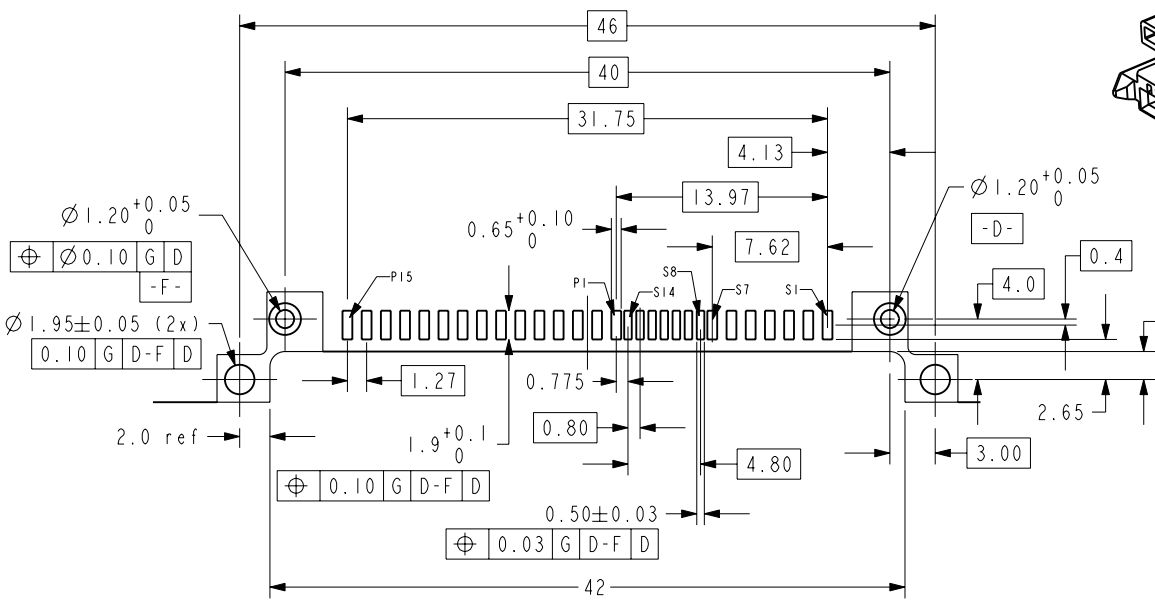

RECOMMENDED PCB LAYOUT
 RECOMMENDED PCB THICKNESS: 1.6mm
 TOLERANCE UNLESS OTHERWISE: ±0.1

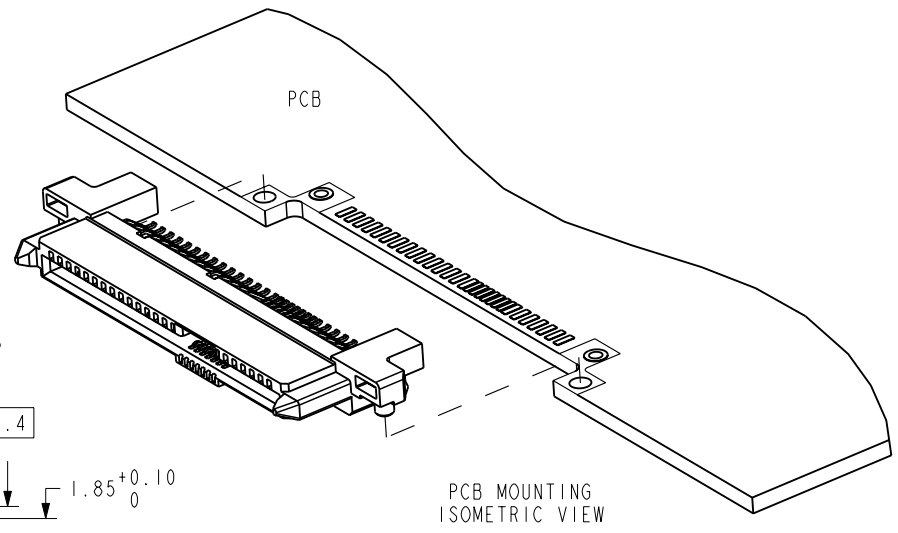

NOTES:-

- MATERIAL:
 - HOUSING: HIGH TEMP. THERMOPLASTIC, UL 94V-0
COLOR: BLACK.
 - TERMINAL: COPPER ALLOY.
 - HOLD DOWN: COPPER ALLOY.
- FINISH:
 - TERMINAL: 30u" PLATING (CONTACT POINT) OVER 50u" MIN NICKEL.
 - SOLDER TAIL: 100u" MIN TIN OVER 50u" MIN NICKEL.
 - HOLD DOWN: 100u" MIN OVER 50u" MIN NICKEL.
- THE STD. PACK IS IN TRAY.
- THE HOUSING WILL WITHSTAND EXPOSURE TO 260°C PEAK TEMPERATURE FOR 10 SECONDS IN A CONVECTION, INFRA-RED OR VAPOR PHASE REFLOW OVEN.
- THIS PRODUCT MEETS EUROPEAN UNION DIRECTIVES AND OTHER COUNTRY REGULATIONS AS DESCRIBE IN GS-22-008.
- PART NUMBERS ENDING IN "LF" MEANT FOR NOTE 5 LEAD FREE IDENTIFICATION. P/N XXXXXX-XXXLF IS EQUIVALENT TO PREVIOUS P/N XXXXXX-XXX.
- ALL SOLDER TAIL MUST BE WITHIN 0.12MM, MAX COPLANARITY.
- A Δ SYMBOL BE NEXT TO ANY DIMENSION, VIEW, OR NOTE WHICH HAS BEEN MODIFIED WITH THE CURRENT DRAWING REVISION.

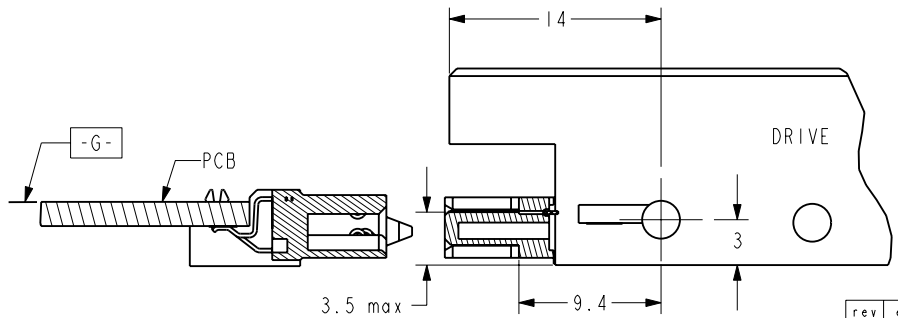

SAS Connector mounting view

rev	ecn no	dr	date
J	S07-0412	JPEH	2007-11-19
B	ECRS05-0020	HOLW	26 JAN05
C	ECRS05-0049	YE05S	22 FEB05
D	ECRS06-0010	TE0CS	09 JAN06
E	ECRS06-0138	JTAN	20 APR06
F	S06-0197	JTAN	05 JUN06
G	S06-0300	TAY	2006-09-12
H	S07-0031	TAY	2007-01-29

www.fciconnect.com		surface <input checked="" type="checkbox"/> tolerance std	projection	MM
		TOLERANCES UNLESS OTHERWISE SPECIFIED		
Dr	JOYCE PEH	2004-08-23	ANGULAR	size A4
Eng	KP TAY	2007-11-19	LINEAR	Scale 2:1
Chr	KP TAY	2007-11-19	2° ±	ECN S07-0412
Appr	JOEY NG	2007-11-19	Product family	Spec ref
FCI SAS RECEPACLE R/A SMT ASSY		dwg no	10035202	
catalog no		CUSTOMER	sheet 1 of 2	



Copyright FCI.

PRODUCT NO.
SEE TABLE

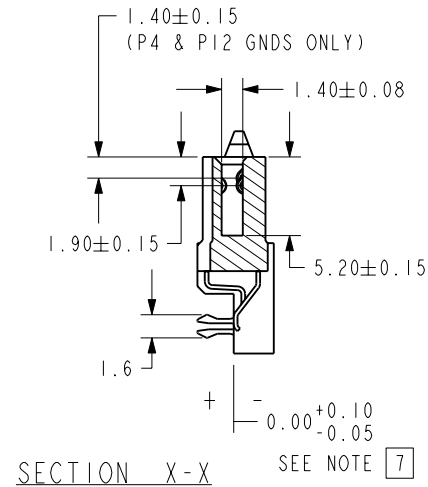
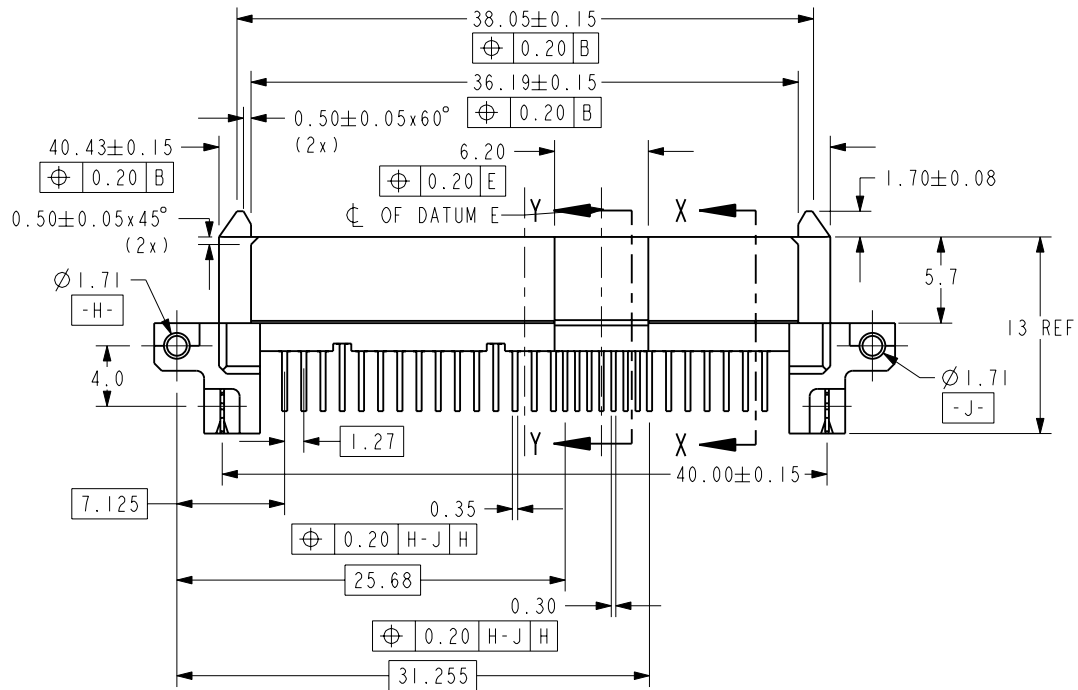
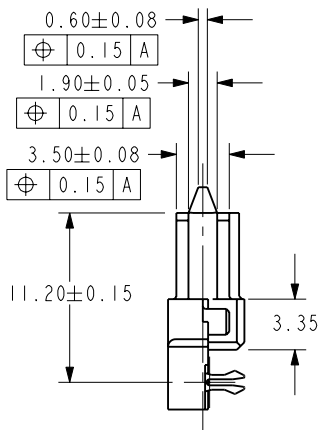
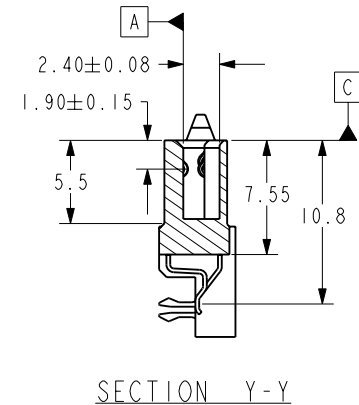
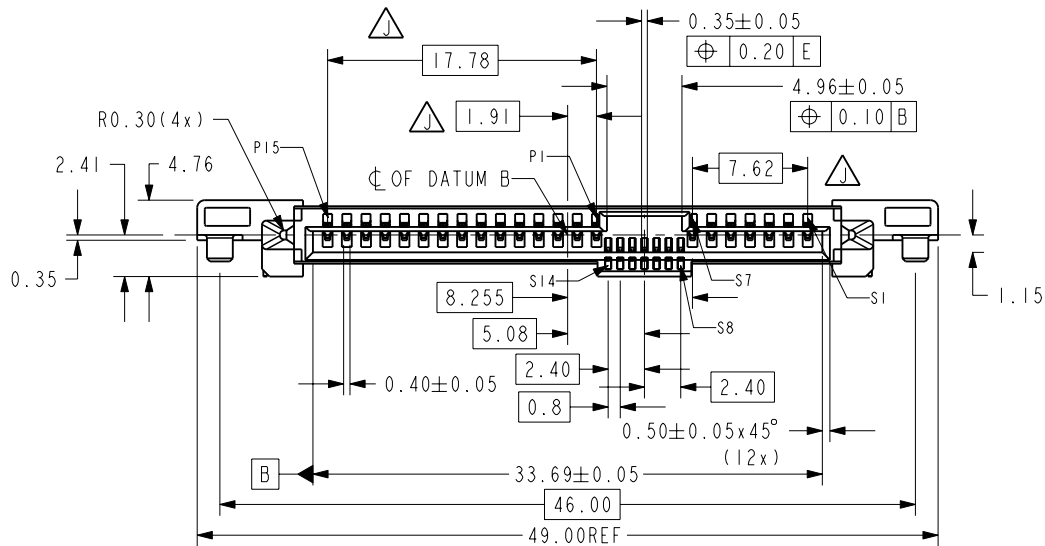

Copyright FCI.



TITLE
SAS RECEPTACLE
R/A SMT ASSY
catalog no

dwg no
10035202

Rev.
J

CUSTOMER sheet 2 of 2